

Instruction manual Tembo 4x4 Rooftop tent



TEMBO 4X4 ROOFTOP TENT

The concept of our rooftop tents is based on more than 15 years' experience in the use, production & selling of rooftop tents. The safety factor and advantage as a lookout position and easy set-up have made rooftop tents very popular.

The ability to test the Tembo 4x4 rooftop tent in the field, over rough terrain and in all-weather conditions worldwide, has enabled us to produce a rooftop tent of strength and reliability in a competitive price range.

Wake up feeling fresh and alive after a good night's sleep on a high-density foam mattress, standard in every Tembo 4x4 Rooftop Tent!

PARTS:

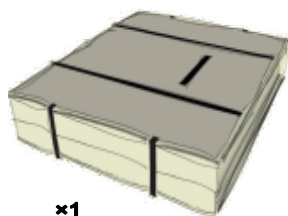

1×Rooftop Tent
(Tent & Foam mattress)



1×Ladder

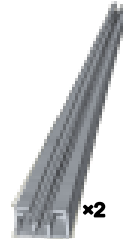

2 x Aluminum bar

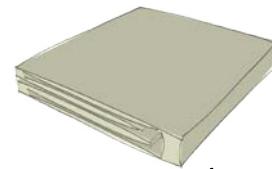

1×Travel Cover

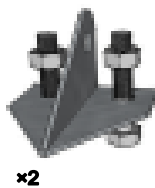

2×Sets for ladder

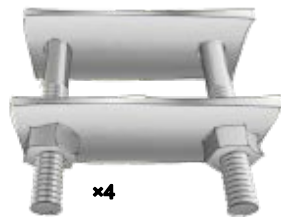

4×sets for Aluminum bar



8× Wires



8×Screw

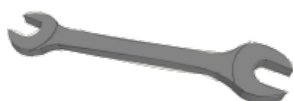

2×Wrench



1×Instruction manual

INSTALLATION MANUAL:

Step 1. Open the tent and take out all accessories.

Step 2. Fix the aluminum bar under the bed base using the predrilled openings

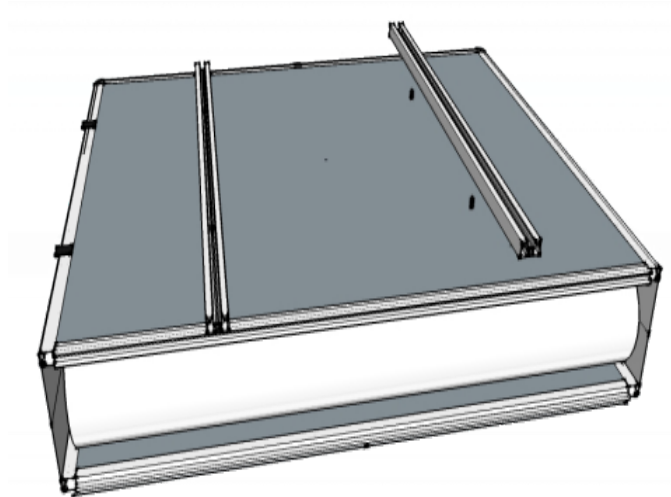

Step 3. Fix the ladder to the tent base using the openings under the bed base

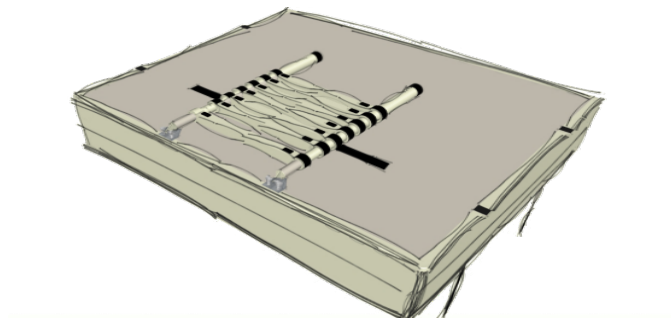

Step 4. Choose the direction in which you want to open the tent

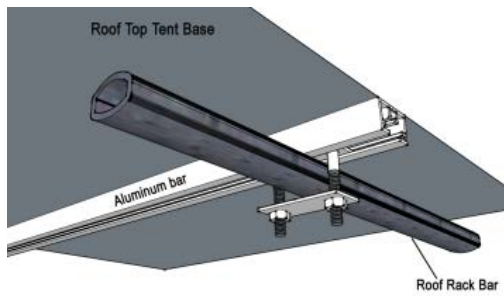

Open the tent to the left side:

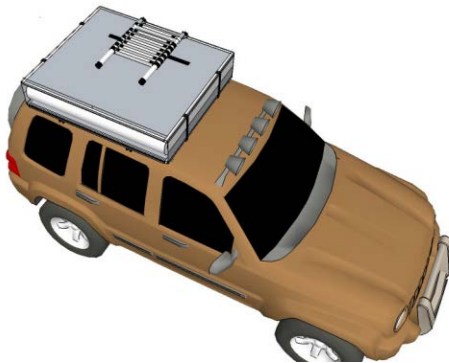

Open the tent to the back:

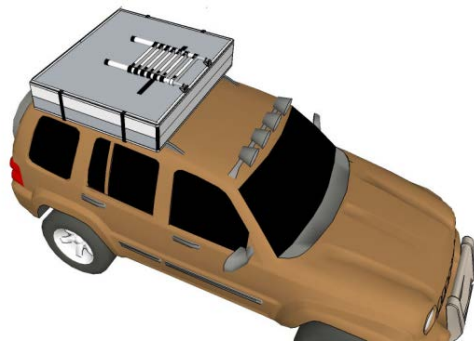

Step 5. Slide the top & bottom cover in the bed base

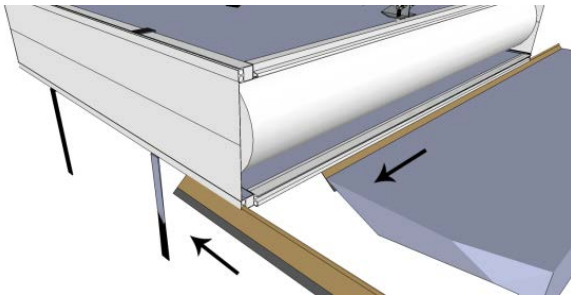

Step 6. Zip up the cover and fasten all straps

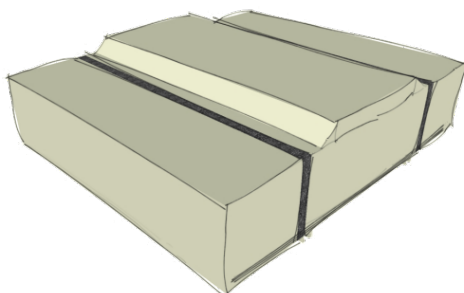

OPERATION INSTRUCTIONS:

Step 7. Unfasten the straps, unzip the travel cover and stretch the ladder



Step 8. Open the tent by pulling the ladder, and adjust the ladder to a suitable position



Step 9. Set up the window & door flap using the springs

Please note: Place the springs in the small drilled holes in the frame of the bed before hooking them in the rings on the flaps and use the long springs for the long side of the tent, and the short springs for the short side of the tent. This way the flaps are tense and water can glide of.



OPTIONAL: Annex tent

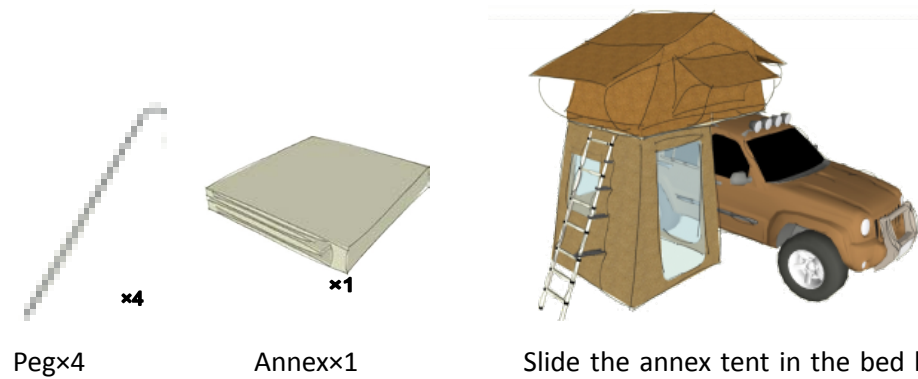

Slide the annex tent in the bed base, adjust it to a suitable position, fasten the straps to the ladder and fix 4 pegs into the earth.

PLEASE NOTE:

Do not move the vehicle when the rooftop tent is set up.

110km/h Speed limit to avoid excessive wear on the travel cover

Please use the ladder according to the ladder instruction

Max load of tent base: 300kg (depends on the vehicle itself at the top of the load-bearing)

Wind force 5 is the maximum wind force for using the Rooftop tent

Please dry the tent as soon as possible after a rainy day, do not pack the tent when it is wet.